

RADIO TRANSMISSION PROBES FOR CNC MACHINE TOOLS

IP68
WATERPROOF

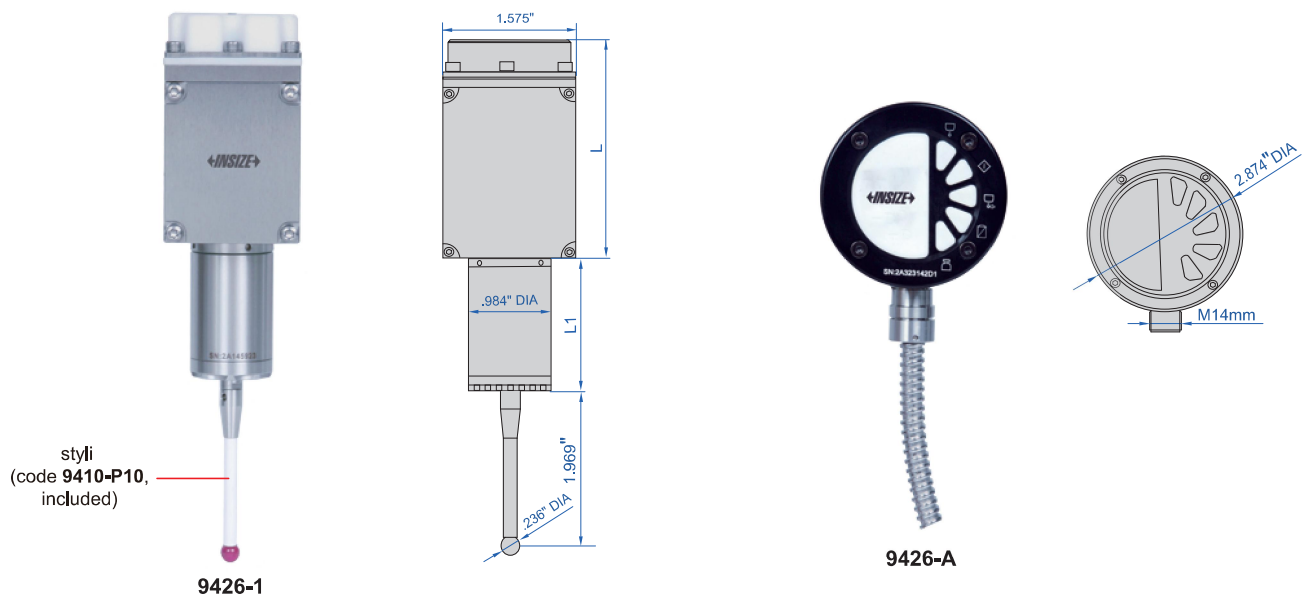

- On-machine measurement of all kinds of lathes, turning centers and mill-turn CNC machines tools
- Automatically set the workpiece coordinate and machining reference point before CNC machining process
- Automatically measure dimension and position coordinate during CNC machining
- Measure dimension, shape and position after CNC machining is completed
- Four kinds of SSR signals such as probe status, error, low voltage and pulse are transmitted to CNC machine tools
- M code is used to control on or off of probes
- Radio transmission, transmission/reception range: 55"
- Supplied with measurement software
- Optional accessory: styli
- Mounting plate can be customized

probe extension rod(included)



PROBE SPECIFICATION

Code	9426-1	9426-2	9426-3	9426-4
Signal transmitter length (L)	2.638"	2.638"	2.638"	2.638"
Probe length (L1)	1.654"	1.654"	1.654"	1.654"
Probe extension rod (included)	—	2"	4"	6"
Trigger accuracy of styli in any direction	39μin			
Protection stroke triggered by styli in all directions	X and Y axis stroke: ±12°, Z axis stroke: .197"			
Trigger force of styli in all directions	X and Y axis: <1.6N, Z axis: <9.8N			
Dust/waterproof	IP68			
Power supply	2xLS14250 lithium battery			

RECEIVER SPECIFICATION

Code	9426-A
Protection function	low battery voltage or probe transmitting signal all the time*
Applicable probe	code 9426-1, 9426-2, 9426-3, 9426-4
Cable length	315" **
Dust/waterproof	IP68
Power supply	input voltage: 24V±10%(DC), load current: 50mA

* When battery voltage is low or probe is in wrong state, receiver sends a signal to CNC machine to stop working

** Cable length can be customized

STYLI(OPTIONAL)

Part No.	L1	L2	d	Material of rod***	Material of ball
9410-P1	.709"	.512"	.157"	stainless steel	ruby
9410-P2	.709"	.531"	.197"	stainless steel	ruby
9410-P3	.728"	.512"	.118"	stainless steel	ruby
9410-P4	.748"	.315"	.079"	carbide	ruby
9410-P5	.768"	.157"	.039"	carbide	ruby
9410-P6	1.969"	1.575"	.079"	carbide	ruby
9410-P7	1.969"	1.339"	.197"	ceramic	ruby
9410-P8	3.937"	3.386"	.236"	ceramic	ruby
9410-P9	1.575"	1.181"	.157"	ceramic	ruby
9410-P10	1.969"	1.417"	.236"	ceramic	ruby

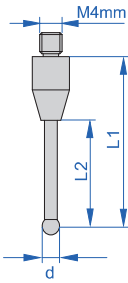

*** For stainless steel or carbide rods, it is recommended to use extension rods to protect spindles in case of break

EXTENSION ROD (OPTIONAL)

Code	Material
9410-R1	ceramic

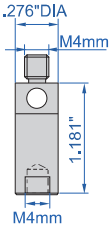

application

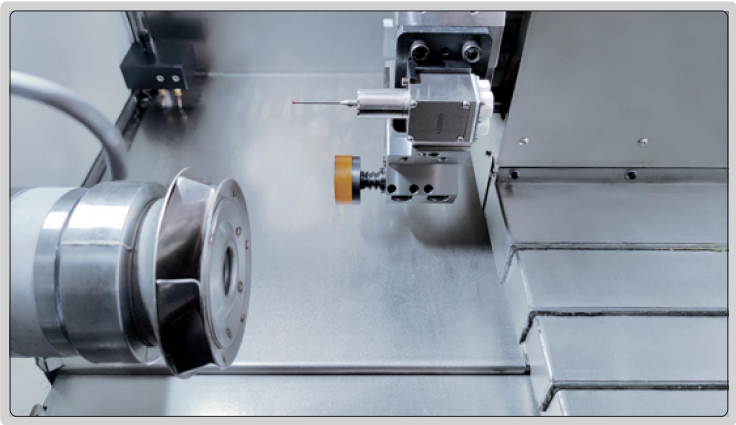

MEASUREMENT SOFTWARE (INCLUDED)

1. Styli automatic calibration
2. Protection of stylus during probe movement (avoid collision)
3. Groove and boss measurement

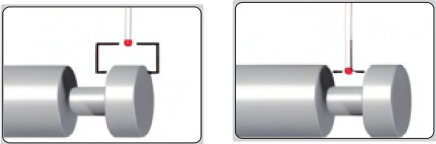

4. Bore and axis measurement

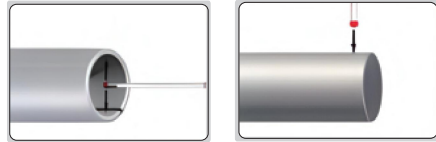

5. Measurement of X and Y axis step plane
6. Measurement of X and Y plane angle
7. Measurement of internal arc in X and Y plane