

ROLLER BEARING V-BLOCK SETS

- Runout accuracy .00020"
- Parallelism of bearings to bottom .00047"
- Two V-blocks per set
- Workpieces don't get damaged due to bearings
- Suitable for heavy workpieces

Part No.	W1	W2	h1	h2	h3	L1	L2	S
6888-1	.87"	1.73"	.79"	3.35"	.47"	3.94"	-	2.36"
6888-2	1.57"	2.36"	.87"	3.35"	.47"	3.94"	-	1.97"
6888-3	2.36"	3.15"	1.18"	4.88"	.79"	7.09"	3.54"	4.72"



6888-1

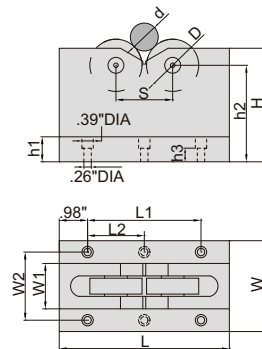

Part No.	Size (LxWxH)	Part No. of bearings	Diameter of bearings (D)	Range of shafts (d)	Load capacity
6888-1	5.9x2.4x3.9"	6303 ZZ	1.65" DIA	.98-2.76" DIA	1100lb
6888-2	5.9x3.1x3.9"	16004 ZZ	1.85" DIA	.20-2.17" DIA	2200lb
6888-3	9.1x3.9x5.9"	6306 ZZ	2.83" DIA	2.76-7.87" DIA	2200lb

