

90° FLAT EDGE SQUARES

- Made of hardened stainless steel

DIN875 grade 0

Part No.	Size (LxW)	Squareness		C	D	H
		Inside (α)	Outside (β)			
4791-50	2.0x1.6"	.00024"	.00024"	.591"	.591"	.157"
4791-75	3.0x2.0"	.00024"	.00028"	.591"	.591"	.157"
4791-100	3.9x2.8"	.00028"	.00028"	.787"	.787"	.197"
4791-150	5.9x3.9"	.00028"	.00032"	1.181"	1.181"	.236"
4791-200	7.9x5.1"	.00032"	.00036"	1.181"	1.181"	.276"
4791-250	9.8x6.5"	.00036"	.00040"	1.378"	1.378"	.276"
4791-300	11.8x7.9"	.00040"	.00043"	1.575"	1.575"	.315"



4791-100

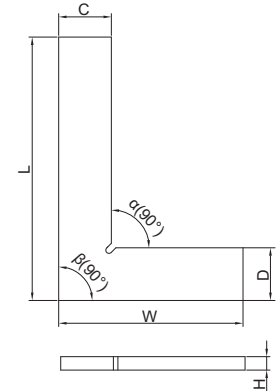

DIN875 grade 1

Part No.	Size (LxW)	Squareness		C	D	H
		Inside (α)	Outside (β)			
4791-501	2.0x1.6"	.00047"	.00051"	.591"	.591"	.157"
4791-751	3.0x2.0"	.00051"	.00056"	.591"	.591"	.157"
4791-1001	3.9x2.8"	.00056"	.00060"	.787"	.787"	.197"
4791-1501	5.9x3.9"	.00063"	.00071"	1.181"	1.181"	.236"
4791-2001	7.9x5.1"	.00075"	.00079"	1.181"	1.181"	.236"
4791-2501	9.8x6.5"	.00083"	.00091"	1.378"	1.378"	.276"
4791-3001	11.8x7.9"	.00091"	.00099"	1.575"	1.575"	.315"

DIN875 grade 2

Part No.	Size (LxW)	Squareness		C	D	H
		Inside (α)	Outside (β)			
4791-502	2.0x1.6"	.00095"	.00098"	.591"	.591"	.157"
4791-752	3.0x2.0"	.00102"	.00110"	.591"	.591"	.157"
4791-1002	3.9x2.8"	.00110"	.00118"	.787"	.787"	.197"
4791-1502	5.9x3.9"	.00130"	.00138"	1.181"	1.181"	.236"
4791-2002	7.9x5.1"	.00150"	.00157"	1.181"	1.181"	.236"
4791-2502	9.8x6.5"	.00170"	.00177"	1.378"	1.378"	.276"
4791-3002	11.8x7.9"	.00185"	.00197"	1.575"	1.575"	.315"