

NON-ROTATING SPINDLE

ABSOLUTE ENCODER, THE ORIGINAL DATA REMAINS AFTER POWER OFF

IP65 WATERPROOF

DATA OUTPUT

HIGH PRECISION ELECTRONIC SPHERICAL ANVIL TUBE MICROMETERS/SNAP GAGES

ONE TURN OF SLEEVE MAKES .2" SPINDLE FEED, PRESS THE FORK, THE SPINDLE RETRACTS .12"

MEASUREMENT ACCURACY IS NOT AFFECTED BY THE USE OF SLEEVE



ATTENTION: RECHARGEABLE BATTERY, FOR 24 HOURS CONTINUOUS WORKING



3355-25

- Measure wall thickness of tubes
- Absolute encoder, the original data remains after power off
- Adjustable resolution: .00001"/0.0002mm
.00005"/0.001mm
.0005"/0.01mm
- One turn of sleeve makes .2" spindle feed
- Measurement accuracy is not affected by the use of sleeve
- Press the fork, the spindle retracts .12"
- Linear ball bearings for ten million times use
- Carbide spindle and anvil
- Measuring force 7-10N.
Customizable measuring force range 2-12N.
Attention: small measuring force will reduce the dustproof and waterproof level
- Button function: data output, tolerance, data preset, data hold, measuring direction change, max./min./TIR, power off time, on/off, zero, mm/inch, adjust resolution
- Supplied with gage blocks for zero setting (except 0-1"/0-25mm)
- Power: rechargeable battery, for 24 hours continuous working

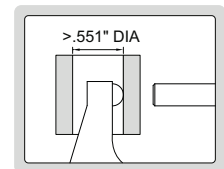
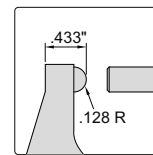
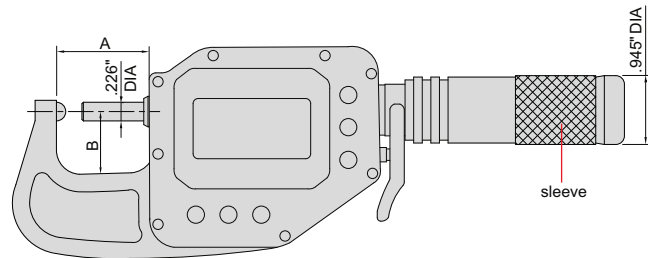

With data interface

Optional accessory:

wireless transmitter, part no. **7315-60**, wireless receiver, part no. **7315-2**, **7315-3**

data output cable (keyboard format), part no. **7302-60**

data output cable (serial port format), part no. **7305-G60**

(cable length 10ft, optional cable length maximum 50ft; RS232 protocol, optional RS485 protocol)

warning when over tolerance

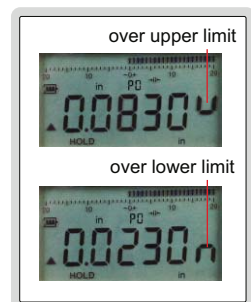

Part No.	Range	Accuracy	Repeatability	A	B
3355-25 *	0-1"/0-25mm	±.00008"	.00004"	1.496"	.945"
3355-50 *	1-2"/25-50mm	±.00008"	.00004"	2.480"	.984"
3355-75 *	2-3"/50-75mm	±.00008"	.00004"	3.464"	1.654"
3355-100 *	3-3.95"/75-100mm	±.00008"	.00004"	4.449"	2.205"

Built-in wireless

Optional accessory:

wireless receiver (keyboard format), part no. **2134-R1**

wireless receiver (serial port format), part no. **2134-R2**

wireless receiver
2134-R1, 2134-R2 (optional)



Part No.	Range	Accuracy	Repeatability	A	B
3355-25WL *	0-1"/0-25mm	±.00008"	.00004"	1.496"	.945"
3355-50WL *	1-2"/25-50mm	±.00008"	.00004"	2.480"	.984"
3355-75WL *	2-3"/50-75mm	±.00008"	.00004"	3.464"	1.654"
3355-100WL *	3-3.95"/75-100mm	±.00008"	.00004"	4.449"	2.205"

* Supplied with manufacturer inspection certificate