

DIGITAL INTERNAL CHAMFER GAUGES

DATA
OUTPUT

PROBE
CAN BE CUSTOMIZED



2937-101

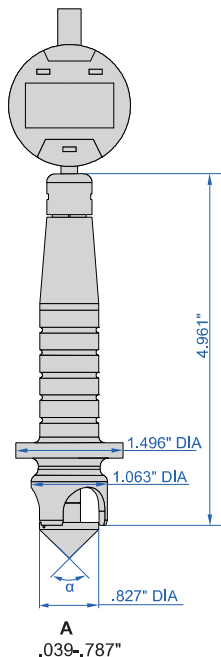

2937-302

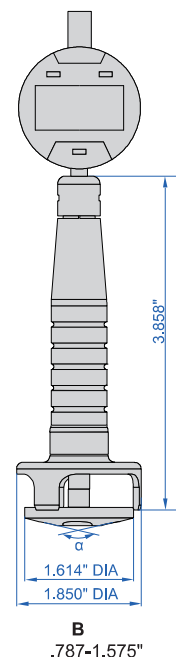

- Measure end diameter of chamfer or taper holes
- Resolution .0005"/0.01mm
- Direct read (end diameter), no calculations
- TiN coated, wear/rust-resistant
- With data interface (optional wireless transmitter part no. **7315-51B**, receiver is needed)

angle $\alpha=90^\circ$

Part No.	Measuring range($\varnothing D$)	Accuracy	Type	Setting ring(included)
2937-101	.039-.787" DIA	$\pm .0010"$	A	$\varnothing 10\text{mm}(.394" \text{ DIA})$
2937-102	.787-1.575" DIA	$\pm .0010"$	B	$\varnothing 30\text{mm}(1.181" \text{ DIA})$

angle $\alpha=130^\circ$

Part No.	Measuring range($\varnothing D$)	Accuracy	Type	Setting ring(included)
2937-201	.039-.787" DIA	$\pm .0010"$	A	$\varnothing 10\text{mm}(.394" \text{ DIA})$
2937-202	.787-1.575" DIA	$\pm .0010"$	B	$\varnothing 30\text{mm}(1.181" \text{ DIA})$

angle $\alpha=150^\circ$

Part No.	Measuring range($\varnothing D$)	Accuracy	Type	Setting ring(included)
2937-301	.039-.787" DIA	$\pm .0015"$	A	$\varnothing 10\text{mm}(.394" \text{ DIA})$
2937-302	.787-1.575" DIA	$\pm .0015"$	B	$\varnothing 30\text{mm}(1.181" \text{ DIA})$

measurement principle

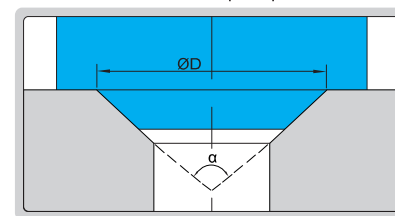

measure end diameter of
chamfer or taper holes

