

DIGITAL EXTERNAL MEASURING GAUGES

DATA
OUTPUT



2934-401

- Measure external dimensions
- Resolution: .00005"/0.001mm
- Accuracy: .00025"
- Repeatability: .00005"
- Movable point stroke: .02"/5mm
- Point height is adjustable, h=.08-1"
- CR2032 battery, automatic power off (time is adjustable)
- Data output

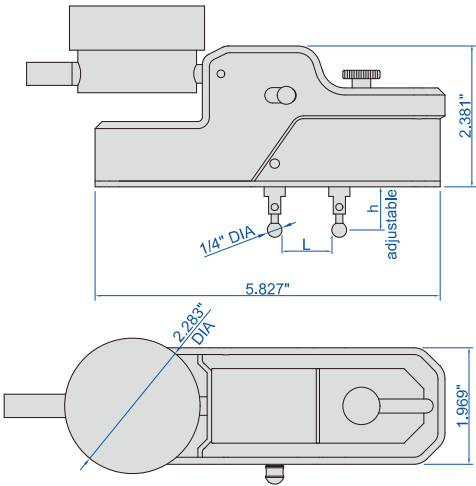

Part No.	Measuring Range (L) *	Indicator	Data output cable (optional)
2934-40	.51-1.5"/13-38mm	Button function: on/off, inch/mm, zero, data preset, change measuring direction, absolute/incremental measurement	7315-50M (need receiver), 7302-40M
2934-401	.51-1.5"/13-38mm	With transmission button and signal light Reading in digital and analog Display can be rotated by 320° Button function: on/off, inch/mm, zero, data preset, change measuring direction, absolute/incremental measurement, max./min./TIR measurement, tolerance Go and No-Go display	7315-51 (need receiver), 7302-40M

* The measuring range will change accordingly for different measuring points

Continued from previous page

Disk points (optional, supplied in pair)

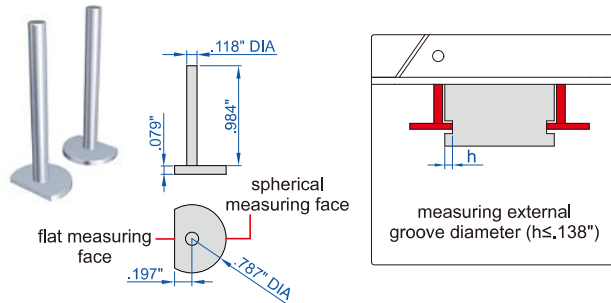

Part No.	Measuring range	Material
2934-S101	.4-1.4"/10-35mm	stainless steel

Conical points (optional, supplied in pair)

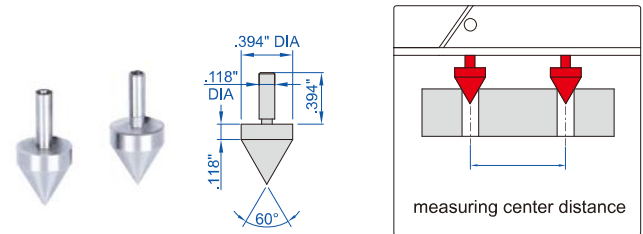

Part No.	Measuring range	Material
2932-S102	.8-1.8"/20-45mm	stainless steel

Flat shoulder points (optional, supplied in pair)

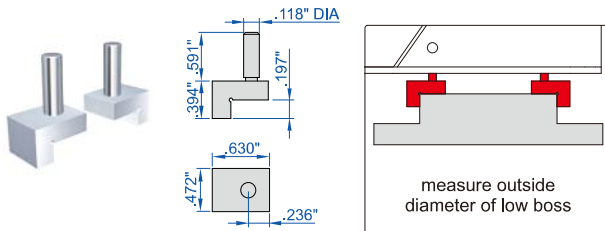

Part No.	Measuring range	Material
2934-S102	1.2-2.2"/30-55mm	stainless steel

Ball points (optional, supplied in pair)

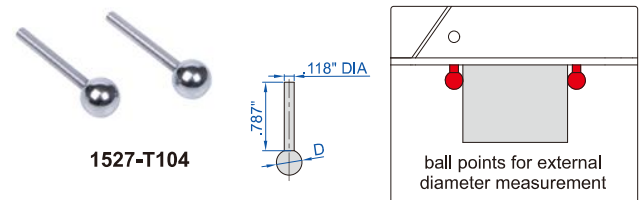

Part No.	Diameter (D)	Accuracy of diameter	Material
1527-T102	1/8" DIA	±.0002"	stainless steel
1527-T103	3/16" DIA	±.0002"	stainless steel
1527-T104	1/4" DIA	±.0002"	stainless steel
1527-T105	3/8" DIA	±.0002"	stainless steel
1527-T106	1/2" DIA	±.0002"	stainless steel