

**ATTENTION: WHEN USING STANDARD PROBE, READING SHOWS MOVEMENT VALUE OF PROBE.
WHEN USING EXTENDED PROBE, READING DOES NOT SHOW MOVEMENT VALUE OF PROBE**

**IP67
WATERPROOF**

**SHOCK
PROOF**



VIDEO

**3D TESTER
INSIZE PLUS**

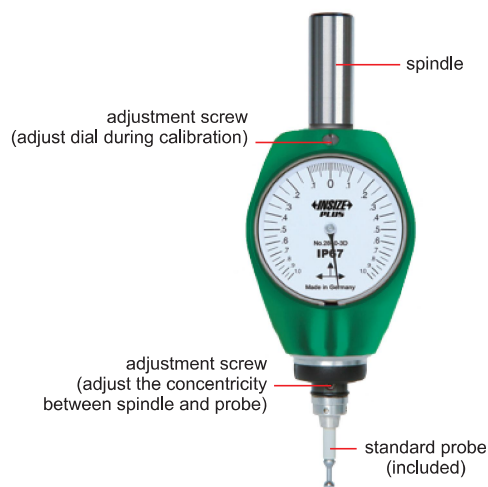

2840-3D

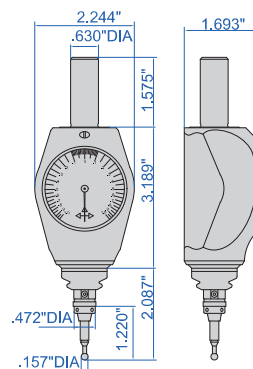

if the probe is pressed too much,
the probe breaks at the breaking point,
in order to prevent damage of the main body

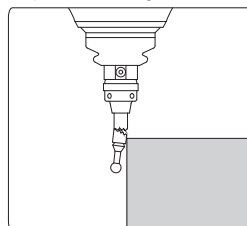

find center of holes

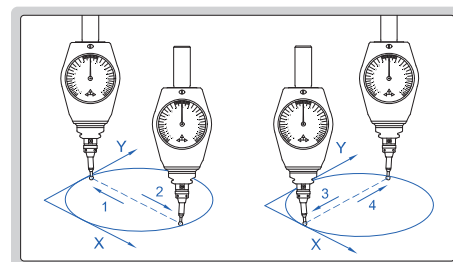

length measurement

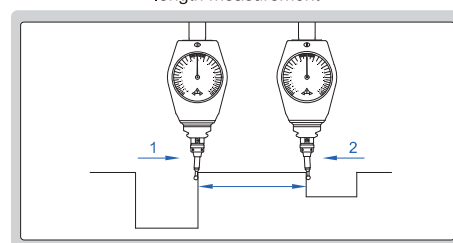

depth measurement

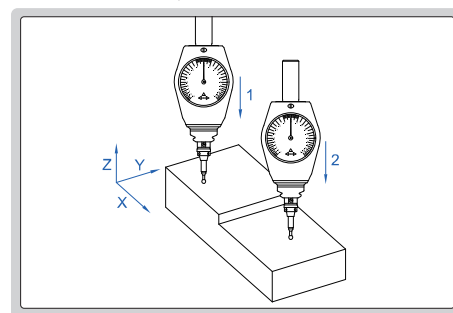

position workpieces

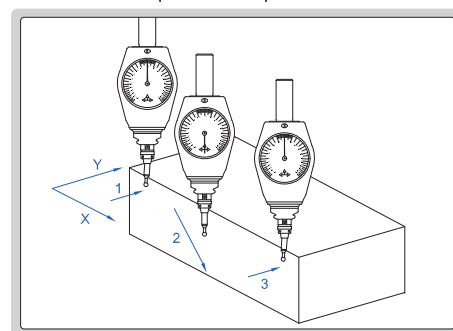

- Shockproof, IP67 dust/waterproof
- Mainly used for milling machines and CNC machine tools
 - determine coordinate point on workpieces
 - find center of holes
 - adjust and position workpieces
- Can be used to measure length and depth
- When using standard probe, reading shows movement value of probe, for example, if probe moves 0.05mm (.002") , reading changes 0.05mm (.002") (5 graduations).
When using extended probe, reading does not show movement value of probe
- Large working range on three axes (X, Y, Z), which avoids damage of probes due to collision by mistake

Part No.	Range	Graduation	Repeatability at zero (one direction)	X, Y, Z range
2840-3D	±1.0mm	0.01mm	±0.01mm	6mm

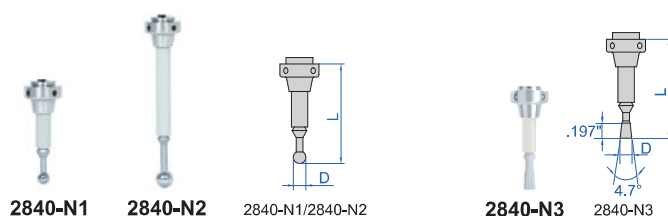

PROBE (optional)

Part No.	Description	L	D	Remark
2840-N1	standard probe	1.220"	.157"DIA	reading shows movement value of probe
2840-N2	extended probe	2.228"	.236"DIA	reading does not show movement value of probe
2840-N3	cone probe	1.220"	.165"DIA	position turning tools in the lathe

position turning tools (cone probe is optional)

set tool to spindle center
(approach cone probe along in X/Y direction with the tool)

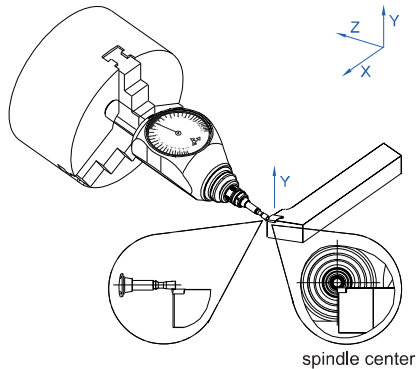
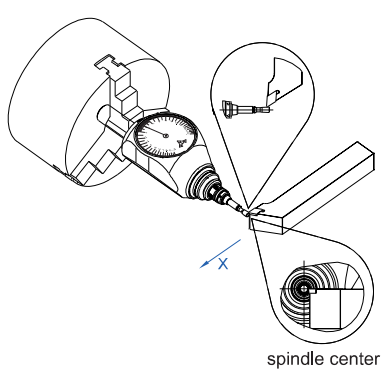

determine tool length
(move the tool to the face of probe)

