



SHOCK
PROOF

JEWELLED
BEARING

PRECISION DIAL INDICATOR

- Meet ASME B89.1.10M-2001
- Shockproof
- Jeweled bearing
- With lug back
- Maximum measuring force: .562lbf
- Supplied with limit pointers and bezel clamp
Optional accessory: backs, contact points



2523-05

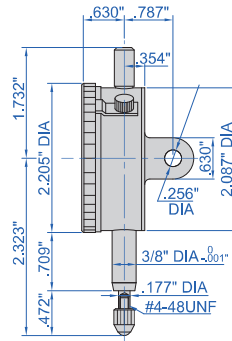

Part No.	Range	Graduation	Accuracy		Range/rev	Cap	Dial reading
			First 2.5 rev	Overall			
2523-05*	.05"	.0001"	±.0001"	±.0003"	.01"	cannot lift	0-100

* Supplied with manufacturer inspection certificate