

ADJUSTABLE COEFFICIENT DIGITAL INDICATORS



2501-10E



2501-25E



2501-25PE



2501-50E

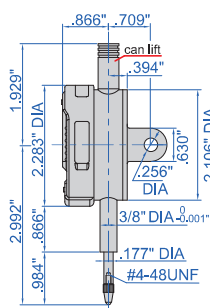

2501-10E
2501-101E

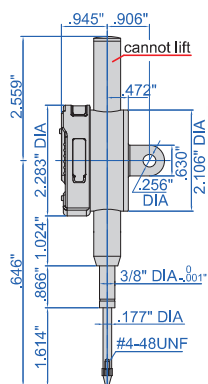

2501-25E
2501-251E

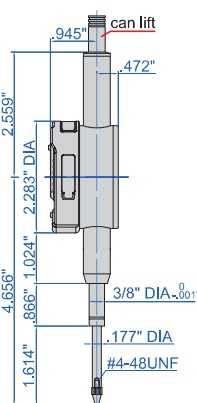

2501-25PE
2501-251PE

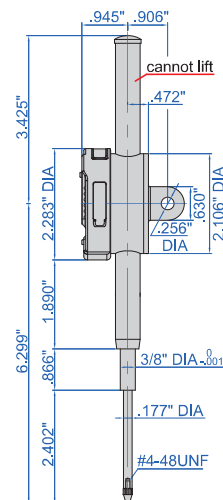

2501-50E
2501-501E

- DISPLAY READING = COEFFICIENT X SPINDLE MOVEMENT
The coefficient (K) can be adjusted from 0 to 9.9999. For example, coefficient (K) is 4.5562, spindle moves .14", display reading is 4.5562 x .14" = .6380"
- Button function: on/off, zero, data preset, inch/mm, coefficient set, measuring direction change
- Switchable high/low frequency measurement mode, high frequency mode is suitable for high speed moving of spindle and has large power consumption, low power consumption in low frequency mode
- Keep preset data in memory after restart
- CR2032 battery, automatic power off (time is adjustable)
- Data output
- Optional accessory:
wireless transmitter part no. **7315-50M** (receiver is needed),
data output cable part no. **7302-40M**, **7305-40M**, backs, contact points

Resolution .00005"/0.001mm

Part No.	Range	Accuracy	Hysteresis	Maximum measuring force	Cap	Remark
2501-101E *	.5"/12.7mm	±.00015"	.00005"	.337lbf	can lift	lug back
2501-251E *	1"/25.4mm	±.00015"	.00005"	.495lbf	cannot lift	lug back
2501-501E *	2"/50.8mm	±.00015"	.00005"	.562lbf	cannot lift	lug back
2501-101FE *	.5"/12.7mm	±.00015"	.00005"	.337lbf	can lift	flat back
2501-251FE *	1"/25.4mm	±.00015"	.00005"	.495lbf	cannot lift	flat back
2501-501FE *	2"/50.8mm	±.00015"	.00005"	.562lbf	cannot lift	flat back
2501-251PE *	1"/25.4mm	±.00015"	.00005"	.495lbf	can lift	flat back
2501-501PE *	2"/50.8mm	±.00015"	.00005"	.562lbf	can lift	flat back

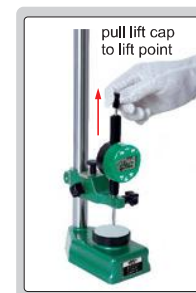

spindle lift knob
is included



Resolution .0005"/0.01mm

Part No.	Range	Accuracy**	Hysteresis**	Maximum measuring force	Cap	Remark
2501-10E *	.5"/12.7mm	±.0015"	.0005"	.337lbf	can lift	lug back
2501-25E *	1"/25.4mm	±.0015"	.0005"	.495lbf	cannot lift	lug back
2501-50E *	2"/50.8mm	±.0015"	.0005"	.562lbf	cannot lift	lug back
2501-10FE *	.5"/12.7mm	±.0015"	.0005"	.337lbf	can lift	flat back
2501-25FE *	1"/25.4mm	±.0015"	.0005"	.495lbf	cannot lift	flat back
2501-50FE *	2"/50.8mm	±.0015"	.0005"	.562lbf	cannot lift	flat back
2501-25PE *	1"/25.4mm	±.0015"	.0005"	.495lbf	can lift	flat back
2501-50PE *	2"/50.8mm	±.0015"	.0005"	.562lbf	can lift	flat back

* Supplied with manufacturer inspection certificate

** The value of accuracy and hysteresis when coefficient (K) = 1